

Quick Reference Guide

Tsmart® INR

with the LabPad® Evolution.

1 Patient identification.

Stand Alone mode

Without patient identification

With a Barcode reader



With a APP for tablet/smartphone/PC

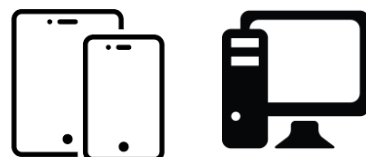

2 Insert the Tsmart® in the LabPad® Evolution until « Click ».

- Use the LabPad® Evolution in a location with sufficient lighting. To perform a test, place your device on a stable, flat, and vibration-free surface.
- Once the pouch is open, the microcuvette should be used within 10 min.
- Insert firmly the Tsmart® INR into the insertion slot of the LabPad® Evolution until you hear a “Click”.

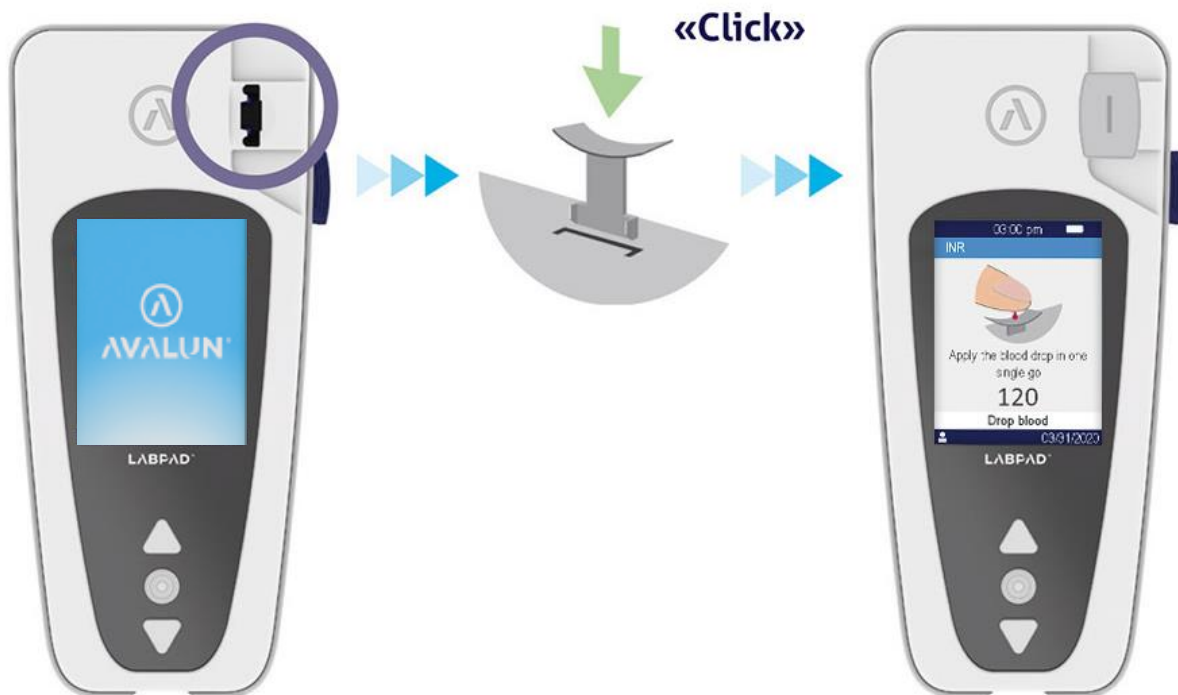

3 Capillary blood collection.



- Clean and dry hands.



- Recommended to use **21 gauge lancets**.

4 Apply the blood drop in one single go.

It is also possible to use micropipettes, **plastic only** (can be provided).

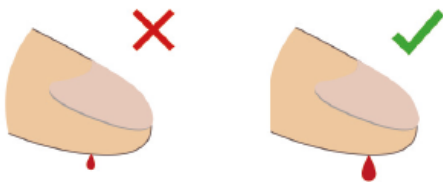

- **5 μ l** of blood is necessary.

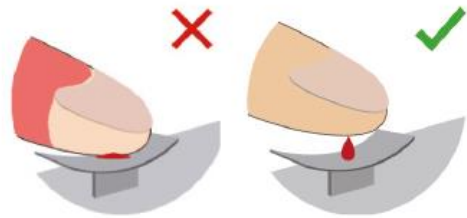

- Do not press the finger on the plate.
- Use a **“Hanging drop”** of blood.

5 Result display.



6 Discard the Tsmart®.

